



14 Lime Close
Frome
BA11 2TX

Guide Price £220,000

A two double bedroom terraced house in a traffic free part on the popular Stonebridge development. Ideally located between the leisure centre and Forest Road Shops. These are great design houses and this one, is an ideal opportunity to make it your own. With an entrance lobby, an open plan living/dining room with a fitted kitchen. There are two double bedrooms on the first floor and a bathroom with a window. Gardens to the front and rear along with drive parking in front of the garage. Gas central heating and double-glazed windows and doors.

Vacant Possession

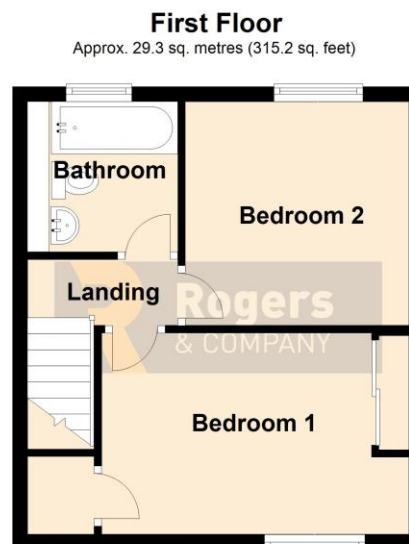
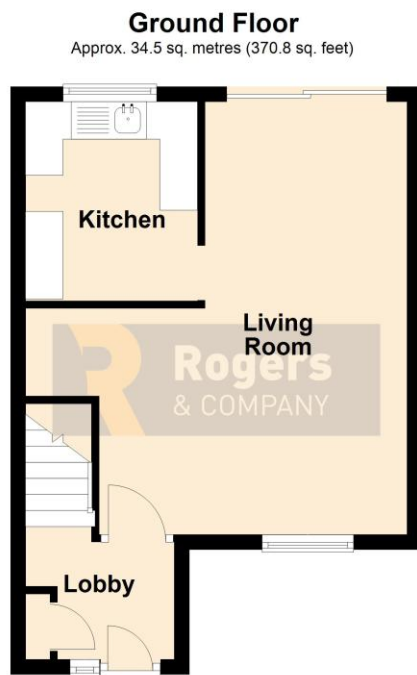

Total area: approx. 63.7 sq. metres (686.1 sq. feet)

Residential Sales

Knowledge and service is key; this coupled with confidence and motivation make this department a formidable force, with local knowledge comes the confidence to be able to offer the service you expect. Knowing the value of your home is very difficult to predict; using our experience and in-trade tools available to us will give you the best chance of achieving the greatest price from the most suitable buyer in a time frame that works with you.

Residential Lettings

Looking after your investment is our main objective, finding quality tenants and maintaining the property to a high standard makes for a 'Happy Tenancy', our no hidden extras fee structure is highly competitive (if not cheaper) than most agents.

Commercial Sales and Leasing

Having been one of the main local commercial agents in the town; over the past decade; we have able to assist in modelling the centre by grouping like minded shops enabling them to support each other. In addition we have let numerous industrial units and office complexes in the Commerce Park, Marston and Wallbridge trading estates to both small and large organisations. We believe being passionate about Frome enables us to convince companies relocating or expanding to the area.



- 662 Sqft Mid Terraced House
- Popular Red Brick 'Kent Homes' Design
- Stonebridge Development on Bath Side of Town
- Two Double Bedrooms
- 19' Living Room
- Kitchen
- Gas Central Heating & Double Glazing
- Good Sized Gardens
- Garage and Drive Parking
- Vacant Possession

- Living Room 19'4" (5.89m) x 13'6" (4.11m)
- Kitchen 9'6" (2.9m) x 7'3" (2.21m)
- Bedroom One 13'3" (4.04m) x 8'10" (2.69m)
- Bedroom Two 9'9" (2.97m) x 9'9" (2.97m)
- Bathroom 6'8" (2.03m) x 6'7" (2.0m)
- Rear Garden 27' (8.22m) x 19' (5.79m)
- Single Garage



Score	Energy rating	Current	Potential
92+	A		
81-91	B		87 B
69-80	C		
55-68	D	68 D	
39-54	E		
21-38	F		
1-20	G		

14 Lime Close Frome BA11 2TX

The tenure is Freehold.

All Main Services are connected.

The Council Tax band is B and is charged at £1,986.20 for 2025/26

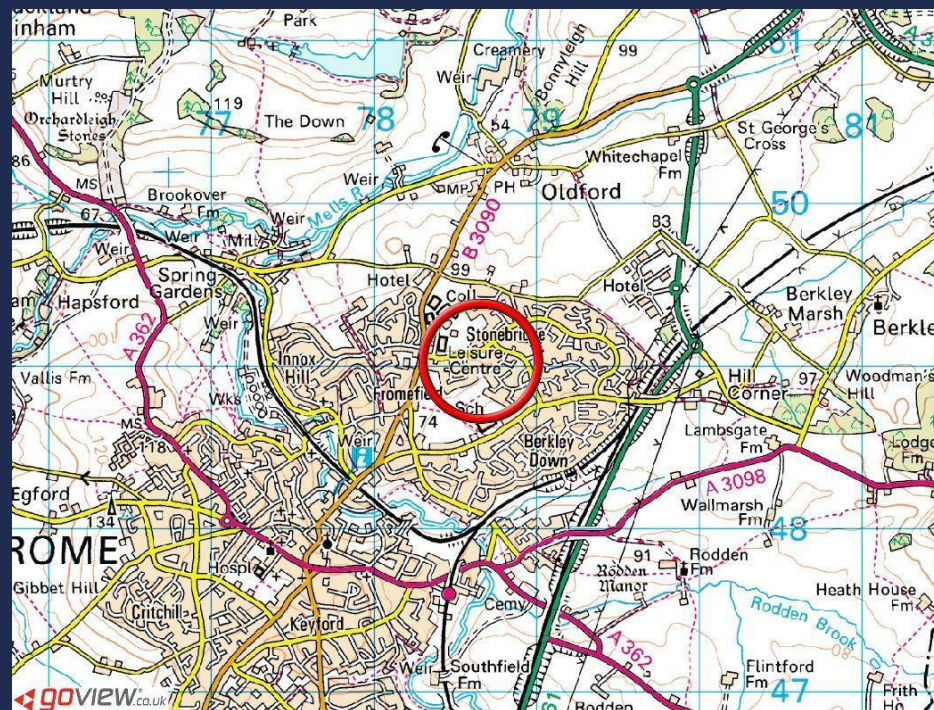

IMPORTANT: we would like to inform prospective purchasers that these sales particulars have been prepared as a general guide only. A detailed survey has not been carried out, nor the services, appliances and fittings tested. Room sizes should not be relied upon for furnishing purposes and are approximate. If floor plans are included, they are for guidance only and illustration purposes only and may not be to scale. If there are any important matters likely to affect your decision to buy, please contact us before viewing the property.

24 Bath Street, Frome, Somerset, BA11 1DJ

T 01373 454 335

E info@rogersandcompany.co.uk

rogersandcompany.co.uk

